

## Configurations

With only one kit provided, Vego modular raised bed is able to assemble into 10 different configurations to fit any backyard space. From the classic 8' x 4' to the long 9'5" x 2'5" or the jumbo square 6' by 6', you can always find one you like.

Note: Due to manufacturing process raised bed sizing may vary +/- 2 inches

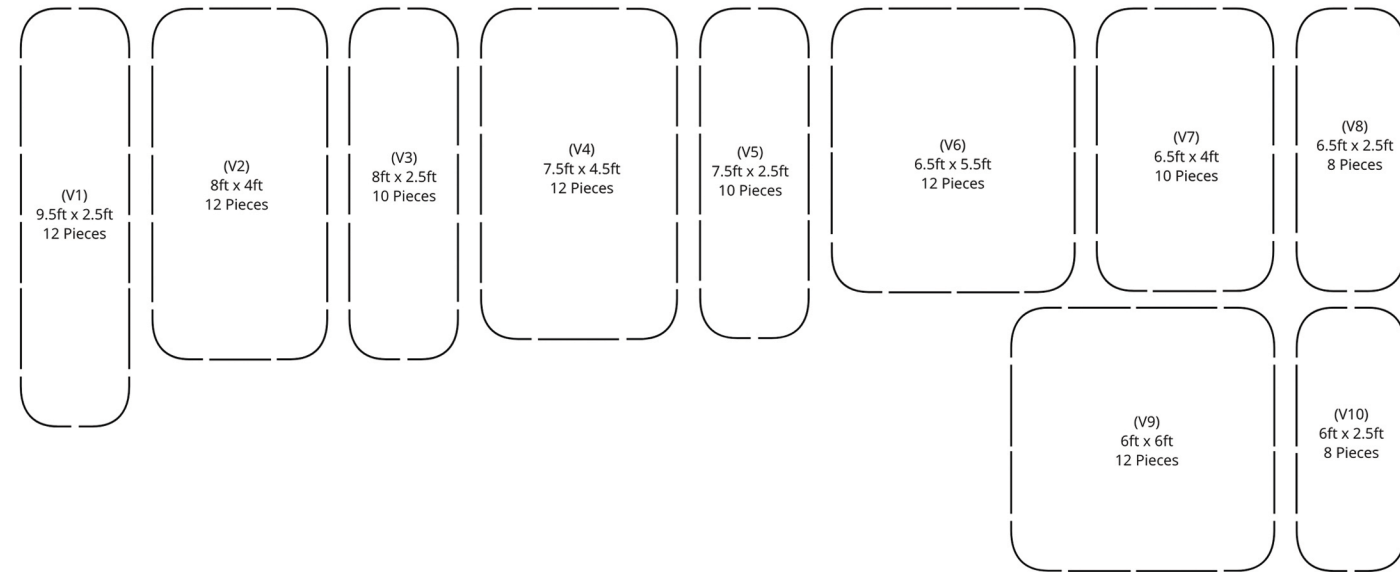

## Dimensions

Configuration	Length (ft)	Width (ft)	Height (in)	Cubic Feet	Cubic Yards
V1	9.5	2.5	32	63	2.3
V2	8	4	32	85	3.2
V3	8	2.5	32	53	1.9
V4	7.5	4.5	32	90	3.3
V5	7.5	2.5	32	50	1.8
V6	6.5	5.5	32	95	3.5
V7	6.5	4	32	69	2.6
V8	6.5	2.5	32	43	1.6
V9	6	6	32	96	3.6
V10	6	2.5	32	40	1.5

## Contact Us

- +1 (628) 220-8868
- hello@vegogarden.com
- www.vegogarden.com
- Houston, TX 77023



vegō garden

EXTRA TALL

10 IN 1 MODULAR  
METAL RAISED BED



### Caution

Please be aware that there are sharp edges in metal panels that may cause injury. The use of protective equipment such as gloves and closed toe shoes is recommended.

# Packing List

A: Corner Panel		X4
B: 1.5ft Side Panel		X4
C: 2ft Side Panel		X4
D: Cap Nut Fastener Set (For Top 2 Rows Use)		X24
E: Standard Fastener Set (For Lower 4 Rows Use)		X48
F: Safety Rubber Edging		X1
G: Bracing Rod (Rod A & Rod B)		X4

# Bracing Rod Installation Guide

## 1 Vego Garden Rods

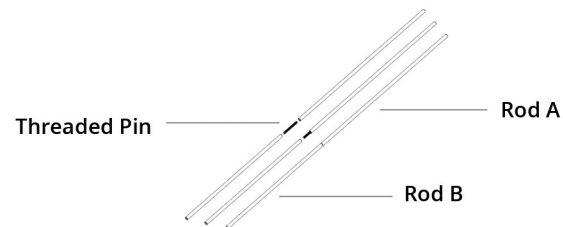

Vego Garden bracing rods are used to reinforce the strength of oversized raised beds. For 2.5ft wide raised bed: use Rod A only; For 4ft wide raised bed: use the Threaded Pin to assemble Rod A & Rod B.

## 2 Rods Installation

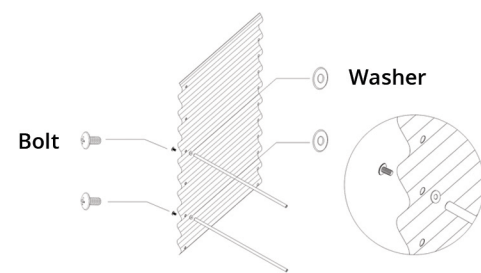

Install bracing rod between the two parallel bolt holes. Attach bolt, panel, washer & rod loosely, making sure that the rods are connected to the **third** and **fifth** bolt holes from the top. Then tighten them up by screwdriver for reinforcement of raised bed.  
**Note:** bolt and washer used for rod installation are the same ones provided in the raised bed kit.

## 3 Assemble Picture

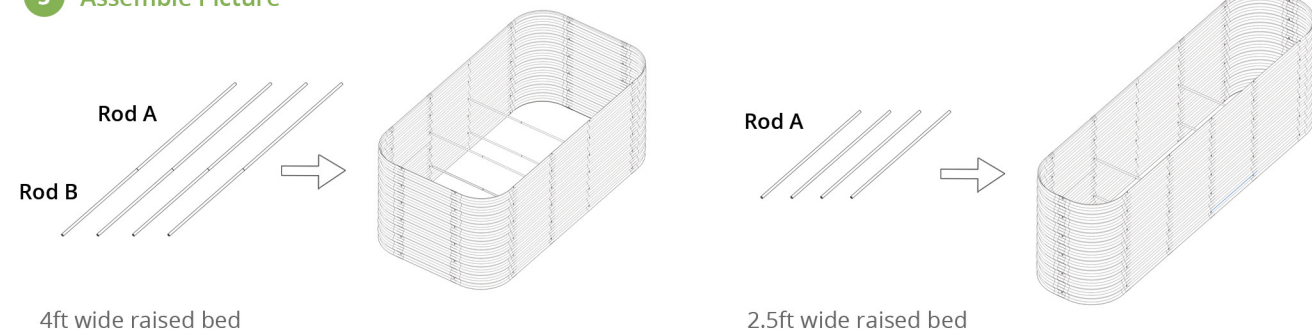

4ft wide raised bed

2.5ft wide raised bed

# Raised Bed Assembly Guide

## 1 Step One

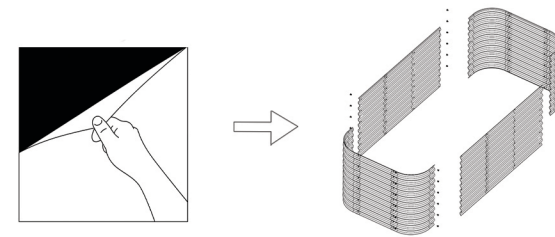

Remove protective films from all panels, and lay panels on a flat surface according to the chosen configuration.

## 2 Step Two

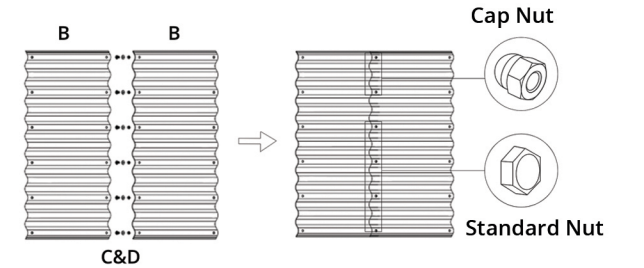

Cap nuts are used for top two rows, standard nuts are used for lower 4 rows. Assemble all straight panels: initially attach all bolts, washers and nuts loosely, and then tighten up using the wrench tool (as supplied) with a screwdriver/cordless drill.

## 3 Step Three

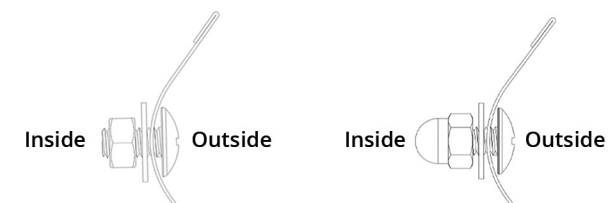

Make sure to tighten each nut and bolt for reinforcement of garden raised bed.

## 4 Step Four

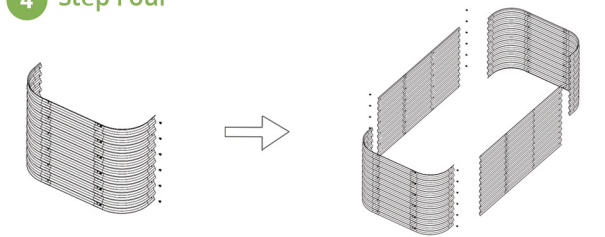

After straight panels are assembled, attach corner panels with straight panels using the same method. Make sure corner panels are attached outside of the straight panels. (Please refer to Bracing Rod Installation Guide for rod assembly instruction.)

## 5 Step Five



Push the safety rubber edging to the top rolled steel edge and cut the extra length off. Make sure edging is attached securely.

## 6 Step Six

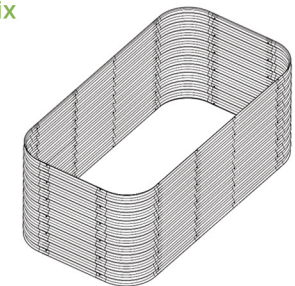

Congratulations on completing the assembly! We are sure there are more configurations that you can do with your great imagination!



@vegogarden



@vego\_garden



#vegogarden / #raisedbedgardening / #metalgardenbed