

# Technical Specifications

Natufia Smart Garden v2.0 [imperial, (metric)]



NATUFIA

## TECHNICAL DETAILS

|                      |   |
|----------------------|---|
| DIMENSIONS           | L 23.3" (593 mm) x W 23.2" (590 mm) x H 79.5" (2019 mm)                         |
| PACKAGING DIMENSIONS | 29.2" (74.1 cm) x 27.9" (71 cm) x 79.9" (203 cm) / 441 lbs (200Kg)              |
| WEIGHT               | Standalone weight 352.74 lbs (160 kg)<br>Operational weight 595.25 lbs (270 kg) |
| MATERIALS            | Stainless steel, glass, PP, HDPE, PS  |
| POWER SUPPLY         | Input 100-240 V<br>50/60 Hz<br>US/EU/UK power plug                              |

## ENERGY USAGE

|                                      |           |
|--------------------------------------|-----------|
| AVERAGE TOTAL ANNUAL CONSUMPTION     | 1,500 kWh |
| AVERAGE LED LAMPS ANNUAL CONSUMPTION | 1,300 kWh |
| POWER CONSUMPTION IN OFF MODE        | 25 W      |
| POWER CONSUMPTION IN ON MODE         | 325 W     |
| MAIN FUSE                            | 3 A       |
| INTERNAL VOLTAGE                     | 24 V      |

## WATER USAGE

|                             |   |
|-----------------------------|---|
| MONTHLY WATER CONSUMPTION   | 52.83 gal (200 L)   |
| TANK SIZE                   | 10.56 gal (40 L)  |
| WATER / DRAINAGE CONNECTION | Machine pipe $\varnothing$ M 3/8; Converter $\varnothing$ F 1/2 BSP |

## PLANT GROWTH MAIN DATA

|                          |                           |
|--------------------------|---------------------------|
| AMBIENT EXT. TEMPERATURE | 64°F - 82°F (18°C - 32°C) |
| PP POTS FOR PLANTS       | 32                        |
| NURSERY CAPACITY         | 34 seed pods              |
| CARTRIDGE CONSUMPTION    | 1 refill every 3 months   |
| PLANT GROWTH TIME        | 10 to 140 days            |

## CONTROL & ALERT SYSTEM

|                                |                                      |
|--------------------------------|--------------------------------------|
| REMOTE (USER / SERVICE CENTER) | Cloud access through WiFi connection |
| UNIT                           | Touch screen                         |

## INSTALLATION OPTIONS

|   |  |
|---|--|
| MACHINE DELIVERED WITH WHEELS (DEFAULT) OR FEET | Upon order   |
| DOOR SIDE                                       | Right hinges as default, can be flipped to left hinges.<br>See installation guide. |
| INTEGRATION BEHIND PANELS                       | YES  |

## MAINTENANCE

|                |                             |
|----------------|-----------------------------|
| CLEANING       | Quarterly / Yearly cleaning |
| NOISE EMISSION | ~ 40 dB                     |

## OTHER

|             |  |
|-------------|--|
| VENTILATION | Silent / Inside fans / From the top            |
| MUSIC       | Playlists: Nature Sounds / Classical / Ambient |

# Machine Dimensions

---

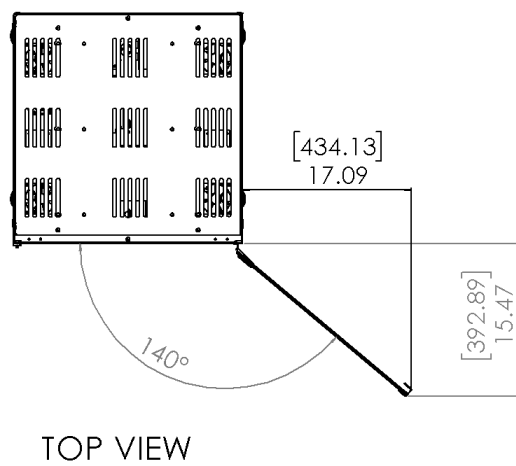
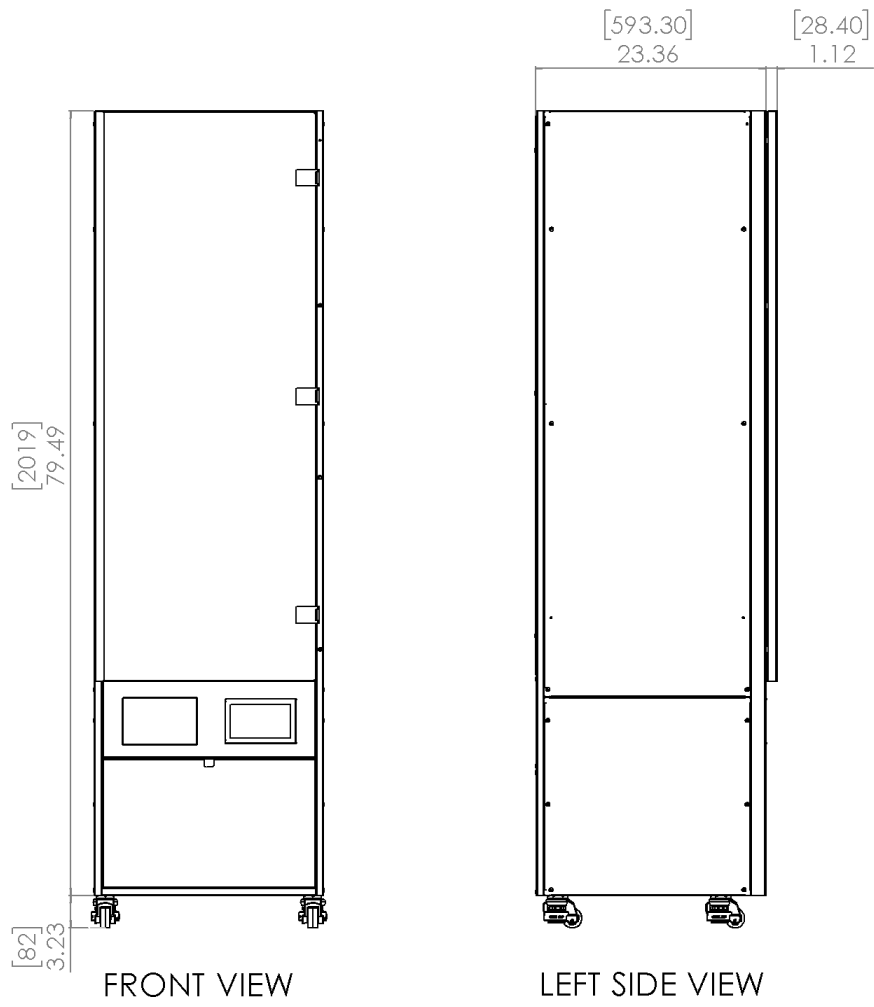

\*Integration behind panels possible. See installation guide.

# Cabinet Dimensions

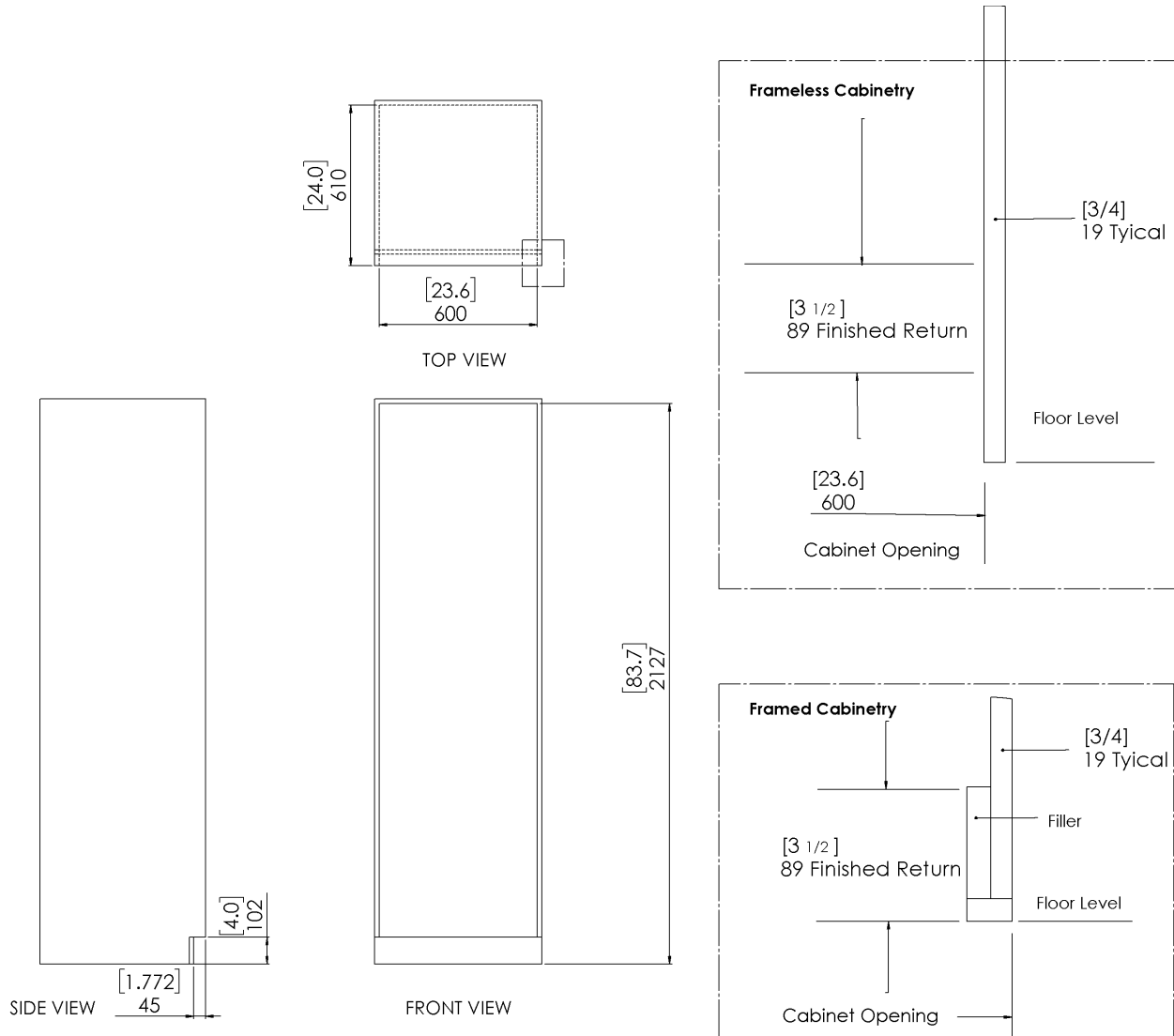

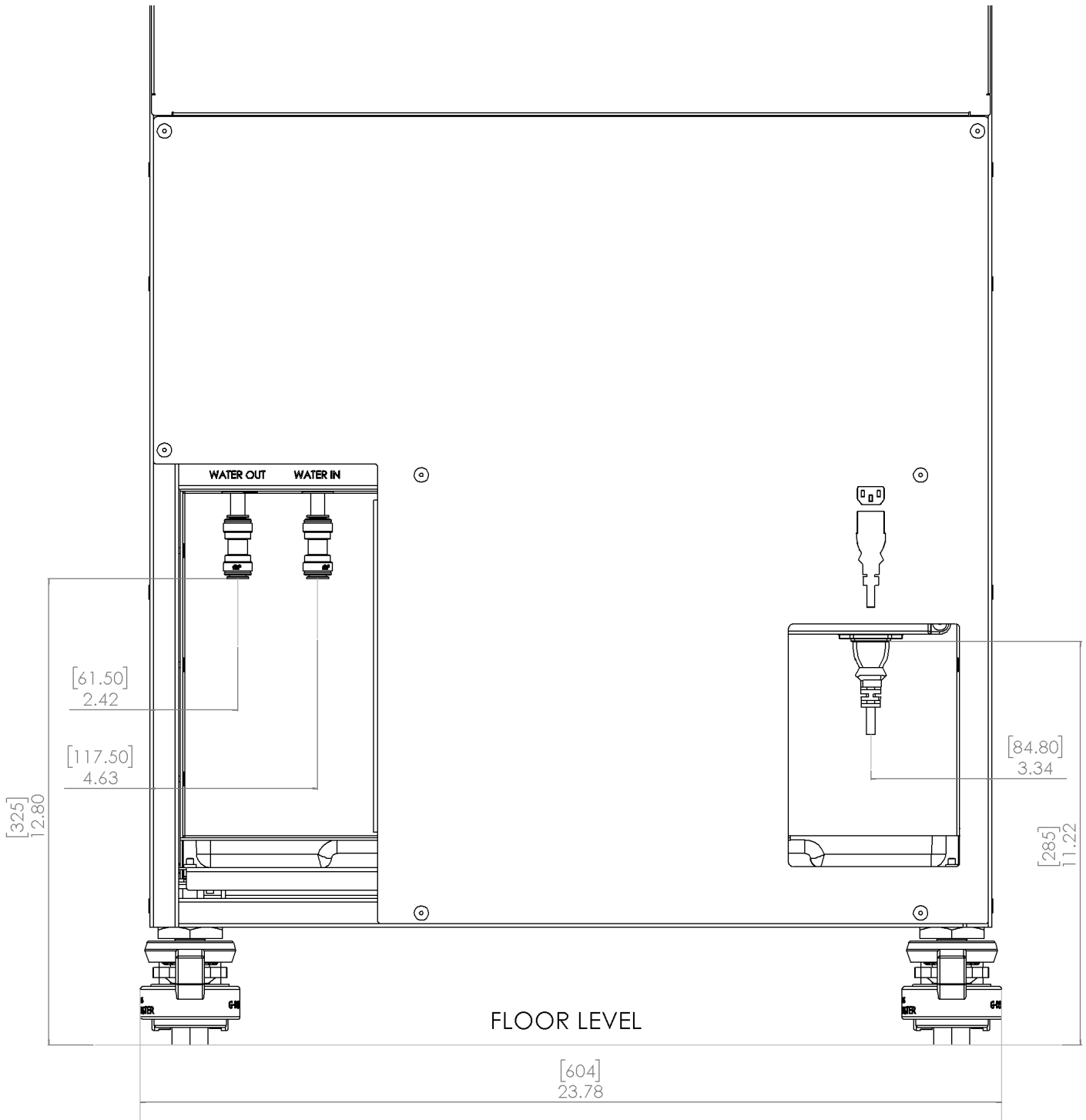

BACK VIEW