

For use in indoor and outdoor agricultural facilities. Suitable for use with plants in the room.

ProKure® V

**Directions for Use:**

It is a violation of Federal Law to use this product in a manner inconsistent with the labeling. Read the entire label and use strictly in accordance with precautionary statements and use.

**DISINFECTANT OR VIRUCIDE\* FOR HARD, NON-POROUS SURFACES:**

Product must be used with an exposure time of 10 minutes at 100 ppm to disinfect hard surfaces.\*\*

**TO EXTEND SHELF-LIFE OF FRUITS AND VEGETABLES:**

This product may be used for one minute at a dilution of 5 ppm in food processing facilities in order to control spoilage microorganisms on raw agricultural commodities (RACs). Apply via sprayer or dip RACs into formulation, followed by a rinse with potable water or by cooking, blanching, or canning. Dilute to 5 ppm as label specifies.

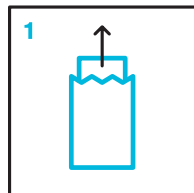

1  
Open the silver foil packet and remove the white pouch. (DO NOT OPEN THE WHITE POUCH.)

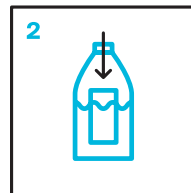

2  
Place the white pouch in an opaque (not clear) container filled with an appropriate amount of water for 100ppm.

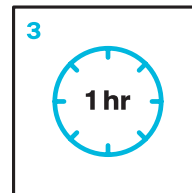

3  
Agitate for one minute at 15 minute intervals until full activation at one hour.

This product, when used in accordance with directions on hard, non-porous surfaces such as stainless steel, glass, vinyl, polypropylene, PVC, or other hard non-permeable surfaces is an effective disinfectant, tuberculocide, fungicide, general-purpose antimicrobial, and surface cleaner. Application sites include cultivation rooms, grow beds, drying rooms, cure rooms, vegetation rooms, propagation rooms, trimming areas, mother room, and drop-down hoses. The formulation may be applied via mop, sprayer, or sponge, with visibly soiled surfaces pre-cleaned as needed by means of a non-disinfectant cleaning agent. Formula must be applied to ensure visible wetness of surface to be treated. Visibly soiled surfaces must be pre-cleaned prior to treatment.

To activate the system, tear open the foil package and remove the white inner pouch. Do not open white inner pouch. Add the pouch to an opaque (not clear) bottle with the correct amount of water as indicated by the table below and agitate for one minute at 15 minute intervals until full activation at 1 hour, for a total of five agitations in one hour's time.

If any formula remains unused, pour unused formula into a dark, closed or sealed container in a cool, dark location that is not subject to any sunlight and is separate from any food for human or animal consumption, making sure to use stored formula within 15 days of activation. Record activation date onto the container. Dispose of stored formula after 15 days.

**To Achieve 100 ppm:**

Size of Pouch	Number of Pouches	Water
<b>ProKure V 3.36oz</b> (wt) (95.2 grams)	1	20 Gallons (75.7L)
<b>ProKure V 0.84oz</b> (wt) (23.8 grams)	1	5 gallons (18.9L)
<b>ProKure V 0.17oz</b> (wt) (5 grams)	1	1 gallon (3.7L)
<b>ProKure V 0.042oz</b> (wt) (1.19 grams)	1	1 quart (946mL)

**NOTE:** Allow ONE (1) HOUR BEFORE USE TO ENSURE SOLUTION REACHES FULL STRENGTH. Be sure to agitate upon addition of the pouch to the water, at 15 minutes intervals, and before initial use. Total of five agitations of one minute for one hour. Temperature must be kept between 20-25°C.

**Use the following dilution instructions. All dilutions are based upon a nominal concentration of 100 ppm. Use the following instructions to achieve the use concentration indicated:**

To Achieve Use Concentration of:	Use Dilution Device or Sprayer with a Dilution Ratio of:
20 ppm	1:5 (one part 100 ppm solution to 4 parts water)
5 ppm	1:20 (one part 100 ppm solution to 19 parts water)

**\*\*DISINFECTANT OR VIRUCIDE\* FOR HARD, NON-POROUS SURFACES:**

Product must be used with an exposure time of 10 minutes at 100 ppm to disinfect: **Bacteria** (methicillin-resistant *S. aureus* (MRSA) (ATCC 33591), *Staphylococcus Aureus* (ATCC 6538), *Pseudomonas Aeruginosa* (ATCC 15442), *Listeria Monocytogenes* (ATCC 19111), *Vancomycinresistant Enterococcus Faecalis* (ATCC 51299), *Salmonella Enterica* (ATCC 10708), and *Mycobacterium Bovis* (TB) (ATCC 35737); **Fungi** (*Fusarium Solani* (ATCC 36031), *Trichophyton Interdigitale* (athlete’s foot) (ATCC 9533), *Candida Albicans* (ATCC 10231), *Botrytis Sp* and *Penicillium Digitatum* (ATCC 201167), and *Aspergillus Niger* (ATCC 9642); kills odor-causing bacteria, mold, and mildew; **Viruses\*** on hard surfaces (in medical or veterinary facilities) to decontaminate Human Immunodeficiency Virus Type 1 (HIV-1) (HTLV-III), Hepatitis A (HM-175), Herpes Simplex-2 (ATCC VR-734), Rhinovirus Type 37 (ATCC VR-1147), Influenza A Virus (ATCC VR-544), Coronavirus (ATCC VR-740), Poliovirus-1 (ATCC VR-1000), Feline Calicivirus (ATCC VR-782), Rotavirus (WA), Canine Parvovirus (ATCC VR-2017), Adenovirus Type 5 (ATCC VR-5), Vaccinia Virus (ATCC VR-119), Norovirus (feline calici used as testing surrogate) (ATCC VR-782), *Bordetella Bronchiseptica* (kennel cough) (ATCC 10580), Canine Distemper Virus, Strain Snyder Hill, (ATCC VR-1587), and Feline Panleukopenia Virus (Feline Distemper) (ATCC VR-648).

Product must be used with an exposure time of 30 seconds at 100 ppm to disinfect: SARS-Related Coronavirus 2 (BEI Resources NR-52281) (Strain: USA-WA 1/2020)[SARSCoV-2]

**SANITIZER FOR HARD, NON-POROUS, FOOD-CONTACT SURFACES:**

Effective food contact surface sanitizer at an exposure time of one minute at a dilution of 5 ppm against E. coli and E coli O157:H7, Staphylococcus Aureus, and Salmonella Typhimurium (MDRS). Product may be used on previously-cleaned food preparation surfaces; fountain drink and beverage dispensers; glassware, plates, and eating utensils and food and beverage processing equipment at a dilution of 5 ppm and an exposure time of one minute.

**FRUIT AND VEGETABLE RINSE ANTIMICROBIAL APPLICATIONS/TO CONTROL THE BUILDUP OF MICROBES IN PROCESS WATERS FOR ASSOCIATED LINES, TANKS, AND FLUMES:**

This product will control and inhibit the build-up of microbes in water used to process fruits and vegetables. The recommended residual concentrations of chlorine dioxide are between 0.25 ppm and 5 ppm. Dilute to 0.25 ppm or 5 ppm as table above specifies. In order to maintain desired concentration, inject formulation to the system either continuously or intermittently as needed. Frequency and volume of replenishment is subject to the severity of contamination of vegetables and fruits being processed, as well as target concentration and process design.

**ANTIMICROBIAL APPLICATIONS FOR NON-POTABLE WATER SYSTEMS IN HORTICULTURAL SETTINGS:**

This product may be used to control and reduce microbial populations in non-potable water used with cut flowers in order to minimize microbial transfer from water to flower in order to maintain/maximize the freshness of cut flowers and to extend their shelf life. Dilute to 5 ppm as table on previous page specifies.

**TO SANITIZE NON-POROUS GLOVES AND SHOES IN ANIMAL AND AGRICULTURAL FACILITIES:**

This product will sanitize gloves and shoes made from non-porous materials such as rubber, neoprene, latex, and water-resistant leather. Prepare product to 100 ppm in accordance with table on previous page. Store the solution in an open container. Remove visible filth from gloves or shoes and dip gloves or shoes into the solution. Treated surfaces must remain wet or be immersed for five minutes. Replace the solution daily or when the solution appears soiled.

**GENERAL SLIMICIDE AND ALGAECIDE (FOR INDOOR AND OUTDOOR AGRICULTURAL FACILITY, GREENHOUSE, HORTICULTURAL, HYDROPONIC, AND CULTIVATION FACILITY APPLICATIONS):**

This product may be used to treat and control fungi, slimes, and algae with an exposure time of 10 minutes at 100 ppm and sanitize (with an exposure time of five minutes at 20 ppm) hard, non-porous surfaces.

**DIP TO CONTROL AND SUPPRESS BACTERIA (such as *Erwinia chrysanthemi*), ALGAE (such as *Phormidium boneri*), AND FUNGI (such as *Penicillium digitatum*, *Botrytis sp.* and *Fusarium solani*) ON ROOTED AND UNROOTED CUTTINGS AND CUT FLOWERS:**

Prepare product to 5 ppm in accordance with table on previous page. Dip cuttings or cut flowers and ensure they remain visibly wet with the solution for at least one minute.

**DIP OR DRENCH TO CONTROL AND SUPPRESS BACTERIA (such as *Erwinia chrysanthemi*), ALGAE (such as *Phormidium boneri*), AND FUNGI (such as *Penicillium digitatum*, *Botrytis sp.*, *Fusarium solani*, *Pythium aphanidermatum*, *Pythium irregulare*, *Fusarium oxysporum f. sp. Basilicum* [Fob]) IN SEED-BED SOIL AND PLANTING CUBES:**

Prepare product to 5 ppm in accordance with table on previous page. Submerge or dip seed-bed soil and/or planting cubes and allow them to remain visibly wet for 10 minutes. Seed-bed soil and/or planting cubes can be seeded or planted immediately after treatment.

**TO CONTROL AND SUPPRESS BACTERIA (*Erwinia chrysanthemi*), INCLUDING ALGAE (*Phormidium boneri*) AND FUNGI [*Penicillium digitatum*, *Botrytis sp.*, *Fusarium solani*, *Pythium aphanidermatum*, *Pythium irregulare*, *Fusarium oxysporum f. sp. Basilicum* (Fob)], ON ORNAMENTALS AND EDIBLES:**

Prepare product to 5 ppm in accordance with chart on Page 2. Submerge ornamentals and edibles and ensure crop is visibly wet for 10 minutes.

## STORAGE AND DISPOSAL

Do not contaminate water, food, or feed by dry pouch storage and disposal.

**Pesticide storage:** STORE SOLUTION IN DARK, DRY, PROTECTED, WELL-VENTILATED AREA, AWAY FROM DIRECT SUNLIGHT AND WHERE TEMPERATURE WILL NOT EXCEED 122°F (50°C). KEEP POUCH CONTAINING DRY INGREDIENTS IN ITS ORIGINAL CONTAINER AND AWAY FROM HEAT OR OPEN FLAME. MAKE SURE THE POUCH CANNOT COME INTO CONTACT WITH WATER OR ACID OR ACID-BASED PRODUCTS.

**Pesticide disposal:** TO AVOID WASTE, USE ALL OF THE SOLUTION ACCORDING TO LABEL DIRECTIONS. DO NOT DISPOSE OF POUCH CONTAINING DRY INGREDIENTS WITH FOOD OR WATER. IN THE EVENT OF A SPILL OF DRY INGREDIENTS, TAKE STEPS TO AVOID RUNOFF TO COME INTO CONTACT WITH COMBUSTIBLE MATERIALS, ACIDIC SOLUTIONS, SKIN, OR CLOTHING. AN UNUSED POUCH CONTAINING DRY INGREDIENTS MUST BE TREATED AS TOXIC WASTE MATERIALS AND MUST BE DISPOSED OF IN ACCORD WITH FEDERAL, STATE, AND LOCAL REGULATIONS. CONTACT EPA, STATE, OR LOCAL ENVIRONMENTAL AGENCIES FOR CURRENT DISPOSAL INSTRUCTIONS. DISCARD EMPTY PACKAGING AND SPENT POUCH IN AN OUTDOOR REFUSE CONTAINER.

**Container handling:** DO NOT REUSE OR REFILL CONTAINER HOLDING SOLUTION EXCEPT AS ALLOWED IN THE DIRECTIONS FOR USE. NONREFILLABLE POUCH. DO NOT TRY TO RE-USE OR REFILL THE POUCH.

## PRECAUTIONARY STATEMENTS HAZARDS TO HUMANS AND DOMESTIC ANIMALS:

This product is designed to fully compartmentalize dry ingredients inside a patented pouch. Under normal conditions of use, and unless the sealed pouch is compromised, contact with the dry ingredients should not occur. However, if the sealed product is compromised and contact with dry ingredients is possible, please note the following hazard and safety information.

**DANGER:** Dry ingredients: Corrosive. Causes irreversible eye damage and skin burns. Wear protective eyewear, such as goggles, face shield, or safety glasses and gloves. Harmful if swallowed. Avoid breathing vapors. Wash thoroughly with soap and water after handling and before eating, drinking, chewing gum, using tobacco, or using the toilet. Remove and wash contaminated clothing before reuse.

#### PHYSICAL OR CHEMICAL HAZARDS:

POUCH CONTAINING DRY SODIUM CHLORITE IS NOT COMPATIBLE WITH ANY REDUCING AGENTS, COMBUSTIBLE MATERIALS, SOLVENTS, ACIDS, PAINTS, OR SULFUR CONTAINING RUBBER. KEEP ACTIVATED SOLUTION AWAY FROM HEAT, SPARKS, AND LIGHT. CHLORINE DIOXIDE GAS CAN BECOME CONCENTRATED IN OPEN AREA OF POUCH. DILUTE ACTIVATED SOLUTION IN AN OPEN, WELL-VENTILATED AREA.

#### FIRST AID

**If in eyes:** Hold eye open and rinse slowly and gently with water for 15-20 minutes. Remove contact lenses, if present, after the first five minutes, then continue rinsing eye. Call a poison control center or doctor for treatment advice.

**If on skin or clothing:** Take off contaminated clothing. Rinse skin immediately with plenty of water for 15-20 minutes. Call a poison control center or doctor for treatment advice.

**If swallowed:** Call poison control center or doctor immediately for treatment advice. Have person sip a glass of water if able to swallow. Do not induce vomiting unless told to do so by the poison control center or doctor. Do not give anything by mouth to an unconscious person.

**If inhaled:** Remove victim to fresh air. If person is not breathing, call 911 or an ambulance, then give artificial respiration, preferably mouth-to-mouth if possible. Call a poison control center or doctor for treatment advice. Get medical attention.

Have the product container or label with you when calling poison control center, doctor, or going for treatment. For emergency information concerning this product, call the National Pesticides Information Center (NPIC) at 1.800.858.7378 seven days a week, 6:30 a.m. to 4:30 p.m. Pacific Time (NPIC). **Note to physician:** Probable mucosal damage may contraindicate the use of gastric lavage.

#### WARRANTY STATEMENT:

Manufacturer's liability is limited to the purchase price of the product. Manufacturer makes no warranties, implied or expressed, other than that the product shall be free from defects in material and workmanship. The manufacturer makes no warranty to the merchantability of the product. Manufacturer accepts no liability resulting from misuse of product or for any incidental or consequential damages for any breach of warranty.

**Made in the U.S.A.**

---

**Distributed By:  
ProKure Solutions, LLC  
5013 E. Washington Street, Suite 130  
Phoenix, AZ 85034  
866.206.1301**

**Control #: 000-00000000**