

4 FT PROPAGATION STAND WITH 4 FT 2 LAMP T5 FLUORESCENT FIXTURE

INSTRUCTIONS FOR USE

FLUORESCENT FIXTURE MOUNTING:

End user must use included rope and the 30 lb max weight fastener. **DO NOT** use the power cord as a means of support! Fixture can not be mounted on a ceiling with radiant heat.

INSTRUCTIONS FOR OPERATION:

1. Remove fixture and stand from box along with all accessories.
2. Set up the stand included in the packaging. The legs will swing around and lock into place when unfolded to the correct angle. Push center brace down into locking position.
3. **Caution: When inserting lamps into light fixture be gentle and rotate the lamps with both hands from the ends. These lamps are fragile!**
4. Insert lamps into the fixture (Make sure on/off switches are in the off position). Slip prongs through fixture's slots and position into receptacle.
5. Each lamp must be rotated into position. Use two hands at each end of the lamp to assist in the rotation.
6. Turn switch(es) to the on position (If all of the lamps do not come on, turn off the power and make sure all lamps are properly inserted and turned 90° from the original position they were inserted into the lamp holders).
7. The fixture is now ready to be hung – mount to the included stand using the #5 Rope and 30# weight fastener.
8. Pull on center rope to raise or lower the light fixture. Use pulley locking mechanism and engage rope brake to hold fixture into position.
9. Plug in the fixture.
10. These fixtures have a daisy chain feature. Plugging more than the specified number of fixtures together is a safety hazard & will void the warranty. **Max 12 of this fixture can be daisy chained together.**

WARRANTY SERVICE:

After properly installing & testing the SuperSprouter® Propagation Stand and Light Fixture, if it still does not work, you should return the product to the dealer where you purchased it. Please make sure you properly test the fixture with lamps that are known to work before you return the fixture. The dealer will be able to further evaluate the light fixture and test its various components and quite possibly will be able to identify and/or fix any problems. If the dealer is unable to fix the SuperSprouter® Propagation Stand and Light Fixture, they will return it to us for factory repair. Proof of purchase is required for warranty work.

FOR WARRANTY SERVICE, PLEASE PACKAGE THE SUPERSPROUTER® PROPAGATION STAND AND LIGHT FIXTURE CAREFULLY IN ITS ORIGINAL PACKAGING. IF IT IS DAMAGED IN SHIPMENT WE CANNOT BE RESPONSIBLE.



Product #960399
stand + fixture

Product #960395
stand only

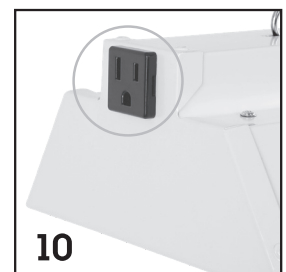
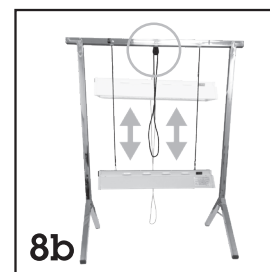
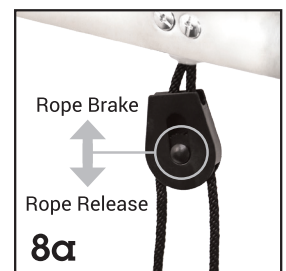
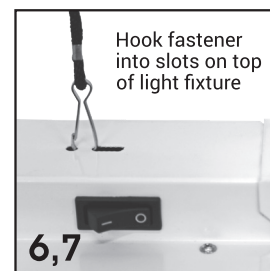
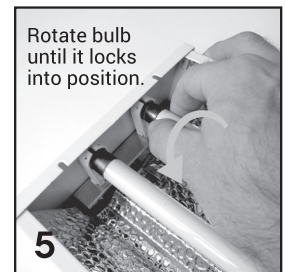
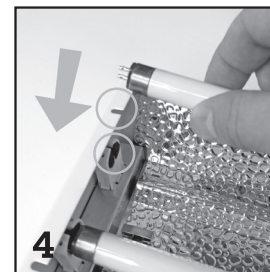
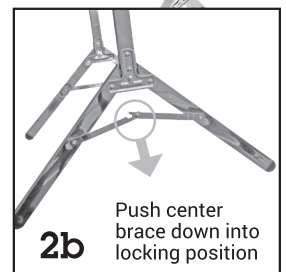
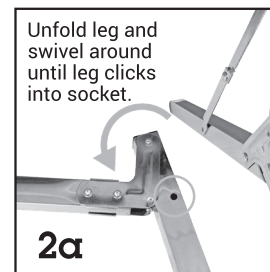

Exclusively distributed by:

Sunlight Supply®

SunlightSupply.com

03152018ST